

Your Remarkable Creators Bundle will arrive in eight pieces:

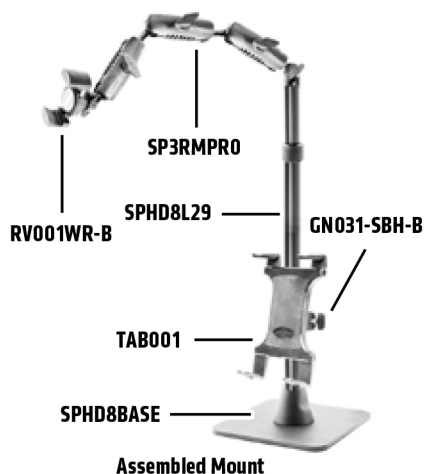

Telescoping pole extends upward from 17 inches to 29 inches.

Compatibility:
Fits smartphones with cases weighing up to 2 pounds and measuring up to 4" wide.

IMPORTANT:
Do not overtighten ring. Overtightening may damage threads on holder and also make it difficult to adjust phone and tablet holders.

- 1 Insert pole into base.
PLEASE NOTE—this will be a tight fit and will require some force.

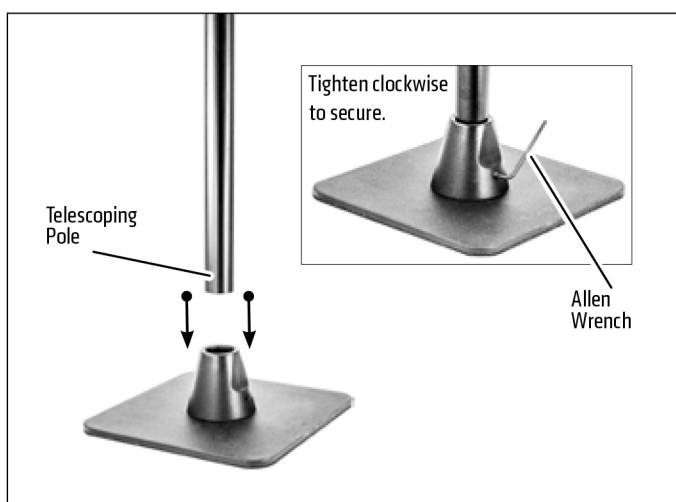

- 2 Attach overhead arm assembly by unscrewing the collar at the top of the pole until the metal ball side of the overhead arm assembly fits into the collar. Tighten collar clockwise to secure.

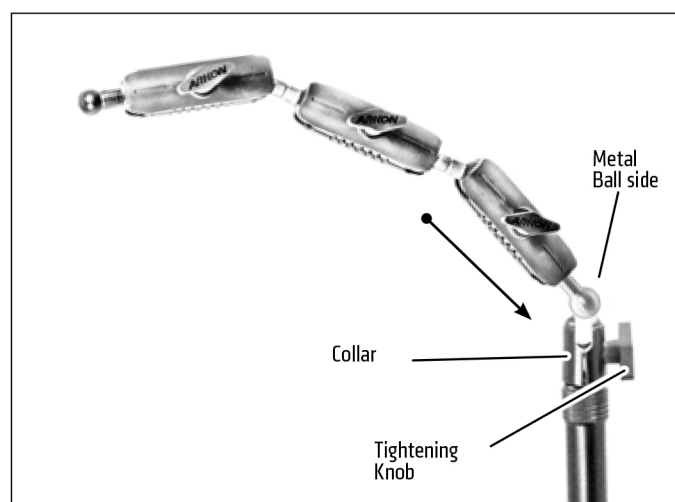

- 3 Unscrew tightening ring from holder. Place ring over the 17mm end of mount then snap the holder onto the ball. Set to desired position, then tighten ring.

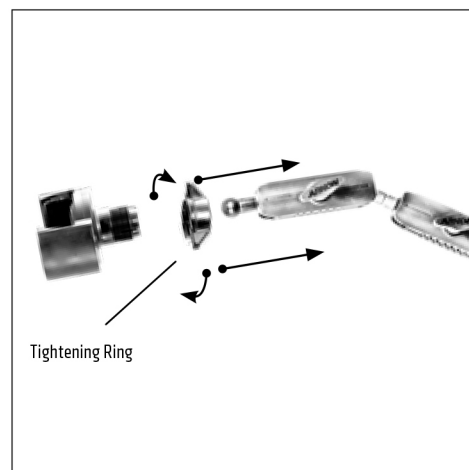

- 4 Using two hands, insert phone into the holder by pushing the device into one of the spring-loaded support arms. Expand the other support arm and fully insert device until it lays flat against the blue rubber pad.



- 5 Shafts can be adjusted by unscrewing the shafts' knobs to loosen. Tighten knobs to set.

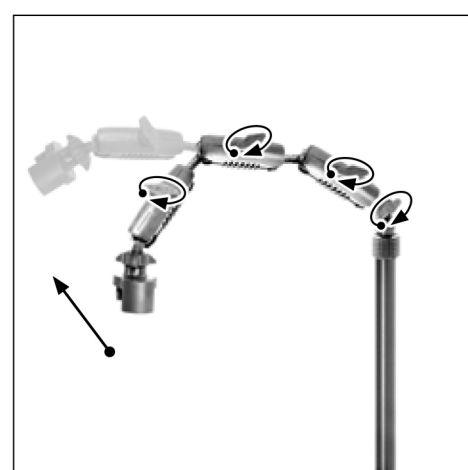

- 6** Adjust the height of the pole by loosening the adjustment collar counterclockwise. Tighten clockwise to set height.



- 8** Unscrew mount's knob to loosen grip. Place mount around pole and tighten knob to secure.



- 10** Ring light clips onto phone.

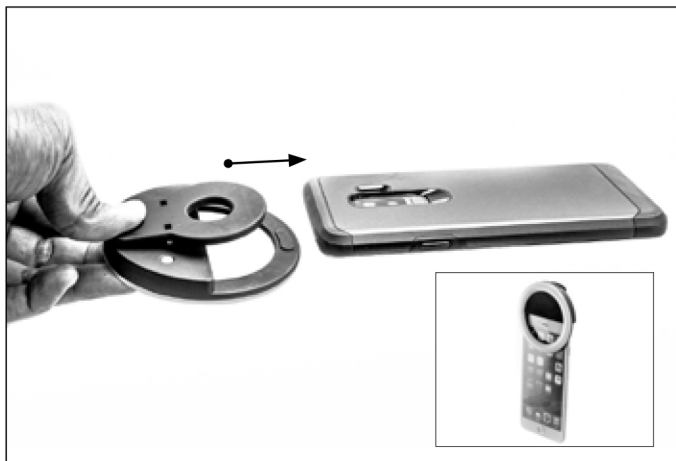

- 7** For instructions on how to assemble tablet holder, refer to included TAB001 manual. Attach tablet holder by inserting the mount's Dual T-Tabs into the holder's Dual T-Slots.



- 9** Push down on lower legs of spring-loaded holder to insert tablet.

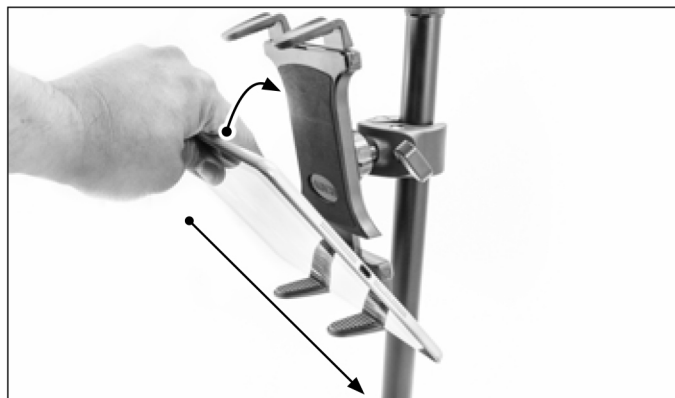

OPTIONAL

To attach **optional** camera/pico projector adapter, unscrew shaft knob and remove phone holder, ring, and ball adapter. Attach the 25mm ball end of the camera adapter to the shaft and tighten clockwise to secure.

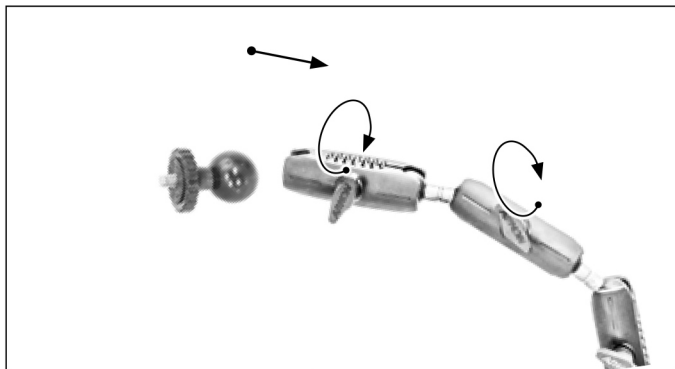

Safety Precautions

Always use two hands (one on shaft, and one on base) when carrying. Failure to properly secure the stand's shaft to the base could cause bodily injury or harm. The Arkon Pro Stand is designed for use with smartphones and small cameras. If using heavier devices, be sure to add a counterbalance in order to prevent the stand from falling over. Arkon Resources, Inc. is not responsible for any damages caused to your device or yourself due to the installation or use of this mount.

ARKON
RESOURCES INC.

Consumer Hotline:

USA (800) 841-0884

INT'L (626) 254-9005

Monday - Friday 9 am - 5 pm, PST

www.arkon.com

Arcadia, CA 91006 USA

Designed in USA | Made in Taiwan

© Copyright 2016 Arkon Resources, Inc.



RCBTABLED
상세페이지 QR코드